

PINOUT (PANEL INSTRUMENTS)

T1=DIRECT POWER (+Vbatt direct)
 T2=IGNITION (STARTER MOTOR)
 T3=KEYON POWER (+Vbatt after KEYON)
 T4=GND
 T5=Glow Plug Module GND (ATM/+Vbatt after KEYON (DPE))
 T6=Pin87 Alternator relay (DPE)
 T7=TRM (signal)
 T8=DIAGNOSTIC - lamp (Fixed light warning & acoustic)
 T9=GLD PLUG ALLARM (Intermittent lamp 1sec - not acoustic)
 T10=ALTERNATOR ALLARM (Fixed lamp - not acoustic)
 T11=OIL PRESSURE ALLARM (Fixed lamp & acoustic)
 T12=ENGINE TEMPERATURE (gauge-signal)
 T13=RPM Signal (from alternator (ATM)/from ECU (DPE))
 T14=COOLANT TEMPERATURE ALLARM (Fixed lamp & acoustic)
 T15=OIL PRESSURE (gauge-signal)
 T16-T17-T18=not used
 T19=CAN LDV
 T20=CAN HIGH
 T21=not connected
 T22=Exhaust Gas Temperature (VETUS engines)
 T23=not connected
 T24=Stop Relay FLY BRIDGE

Amphenol
 - C146180964000 (contacts holders)
 - C146180964000 (custody)
 - H0201600021 (socket contacts 0.5mm)
 - V0201600051 (socket contacts 2.5mm)

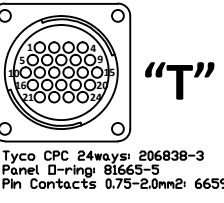
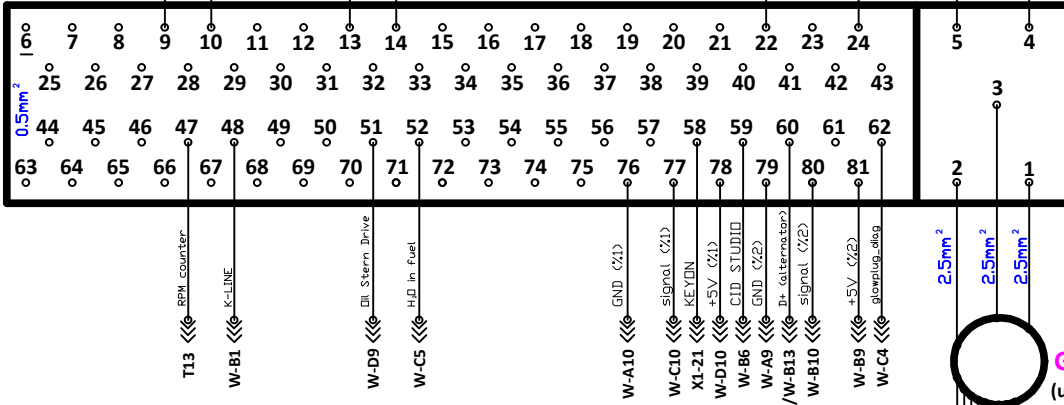
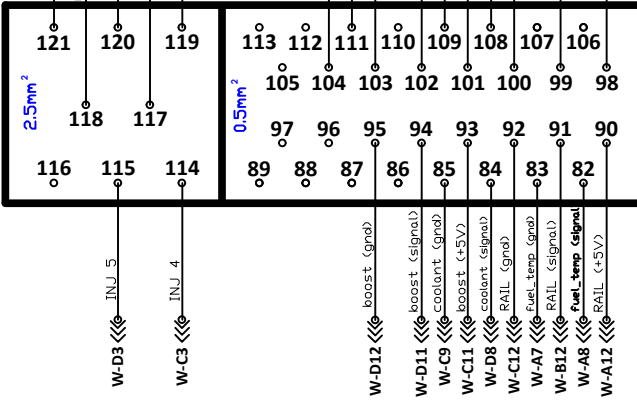
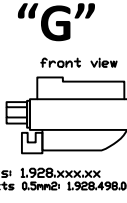
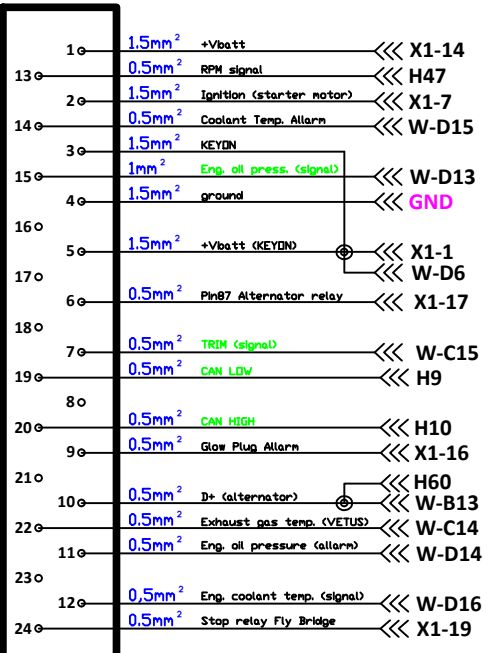
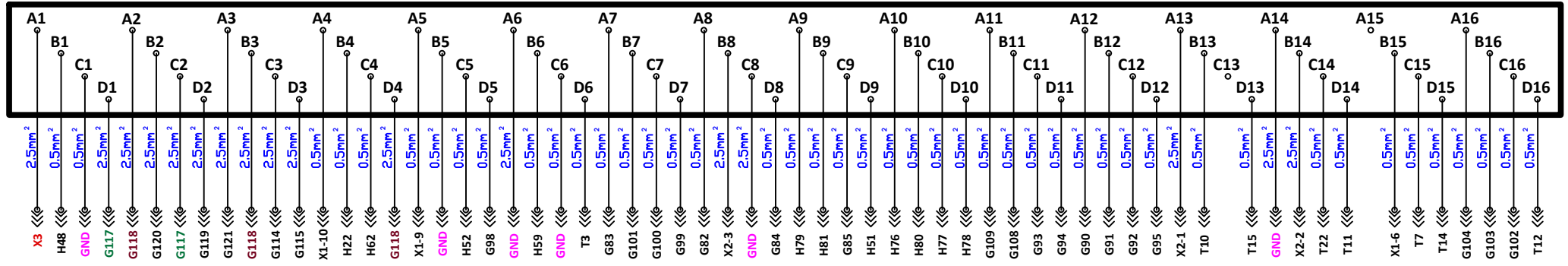

INTEGRATED ON THE PCB (MAIN BOARD)

FNM
 J1=R12=0ohm mounted
 J2=R13=0ohm not mounted

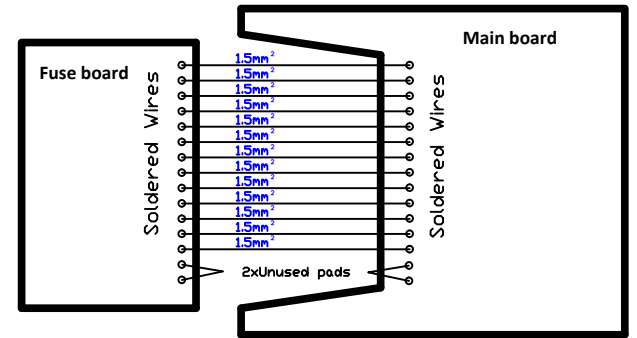
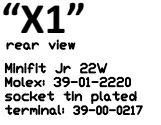
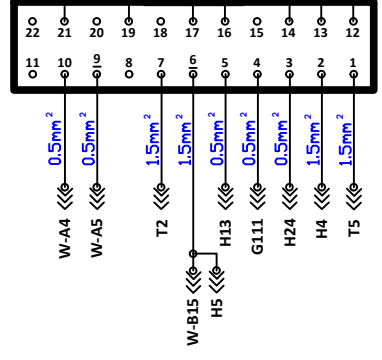
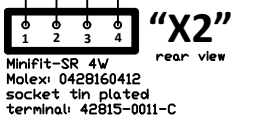
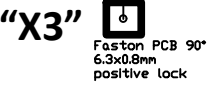

FNM Board: 4.021.009.1

- FUSES (12V)**
- F1 = 10A (Unused)
 - F2 = 10A (VETUS Glow Lamp Relay + Alternator Lamp)
 - F3 = 30A (STARTER MOTOR)
 - F4 = 10A (EOBD Diagnosis)
 - F5 = 10A (KEYON ECU)
 - F6 = 10A (MAIN RELAY - pin5 ECU + coil fuel pre-heat relay)
 - F7 = 10A (MAIN RELAY - pin4 ECU + coil glow plug module)
 - F8 = 3A (OUT MAIN RELAY - coil glow plugs module)
 - F9 = 15A (FUEL PUMP - low pressure circuit)
 - F10 = 15A (FUEL PRE-HEATING)

- RELAY**
- K1 - MAIN
 - K2 - STARTER MOTOR
 - K3 - POWERON
 - K4 - FUEL PUMP
 - K5 - FUEL PRE-HEATING (FUEL FILTER)
 - K6 - FLY-BRIDGE STOP RELAY
 - K7 - GLOW LAMP (Vetus only)
 - K9 - ALTERNATOR LAMP

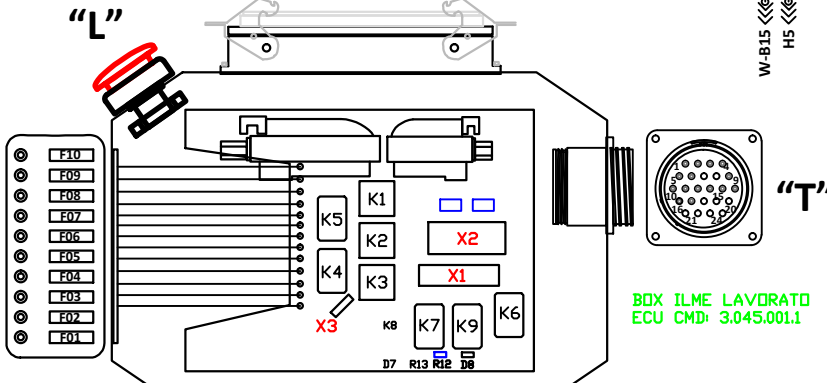

BOX ILME LAVORATO
 ECU CMD: 3.045.001.1

NOTE: K8 e D7 not mounted (default).



CMD (Costruzione Motori Diesel) strada statale 87
 km 23.300 81020 San Nicola La Grada (Caserta)-Italy

PROGETTO FNM
 ECUBOX CANBUS/ANALOGICO

Codice: 4.011.002.1 (FNM)

PINOUT

SCALA

Nome file: 4.011.002.1 (Wiring ECUBOX FNM) Rev3.dwg	Assy sup:	Foglio:	F.to: A3
Progettato da: CUOMO GIUSEPPE	Data:	Firma:	Controllato da:
			Data: 03/02/2011
			Firma: